

THE WORLD OF ECO SCHULTE



■ SYSTEM TECHNOLOGY FOR THE DOOR

THE WORLD OF **ECO SCHULTE**

Door closer

Door operator

Handles

Panic bars and locks

Hinges

Accessories

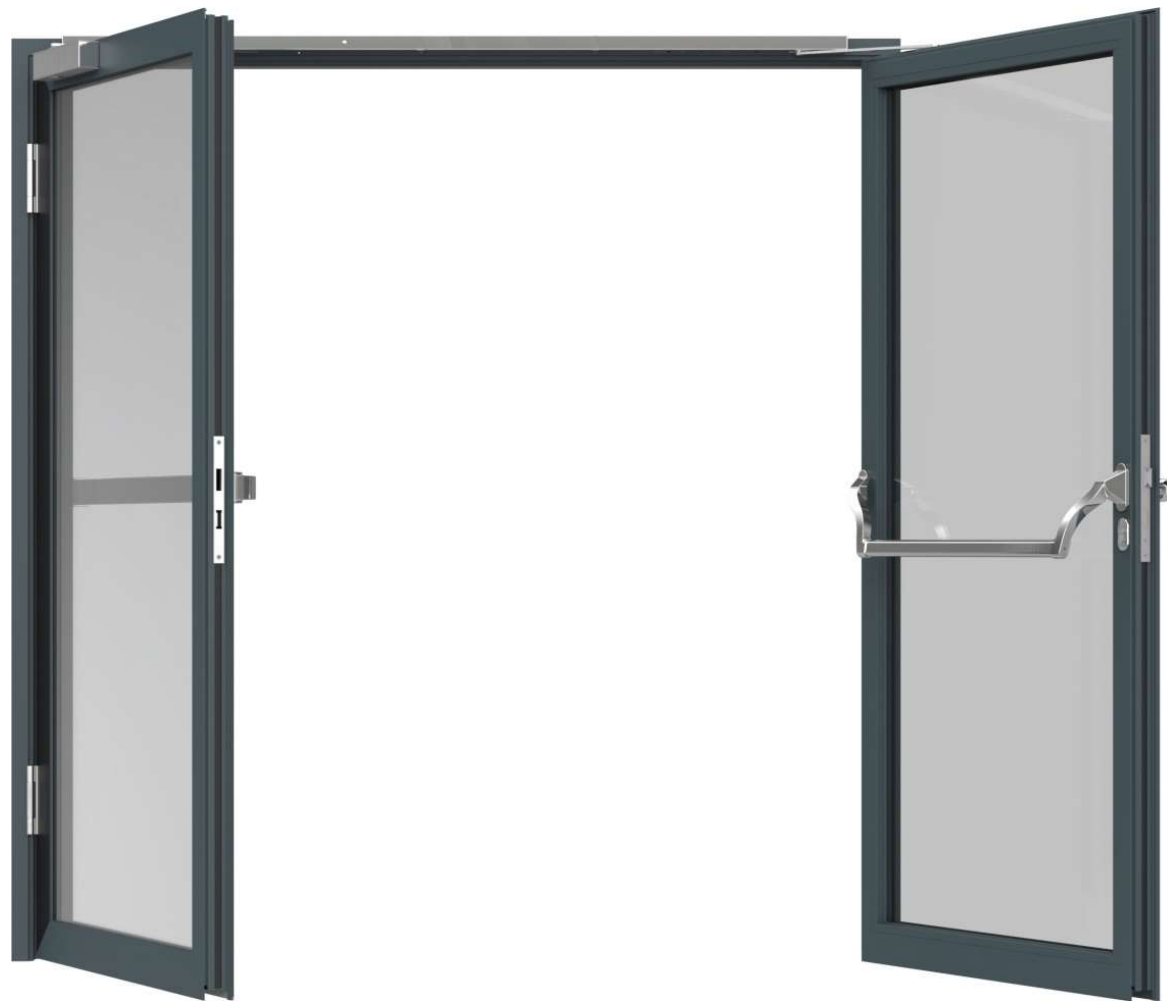

ECO

THE WORLD OF **RANDI A/S**



The Danish handle manufacturer is since 2014 part of the ECO Schulte Group

“Designed by architects for architects”



Randi Line Komé



Randi Line Wing



Randi Line Nordic



WE ARE **FAMILY**

What started in 1926 as a small craftsman's workshop is today a highly recognized producer of door hardware systems

The charm of the family business in contrast to a corporate group:

Continuity, decisiveness and high flexibility.

And a love of doing business.

Andrea Widmann, Heinz and Tobias Schulte
– and their father, **Ernst Schulte**



WE ALSO **PRODUCE**

If you enter a market as a system provider you must also have a command of the system.

The concept of the company network includes fulfilling defined core competencies with our own production.



ECO GLOBAL **WORLDWIDE PRESENCE**



ECO head office Menden



ECO production site Luckenwalde



ECO sales office France



ECO sales office Austria



ECO sales office Poland



ECO head office Zhuhai/ China



Randi production site Denmark

ECO GLOBAL MARKETS



ECO

- Global workforce about **650** employees
- Export in **55** countries
- Export sales > **55 %**

- One of the major supplier for the door manufacturer industry in Europe
- Highly successful in the global project business

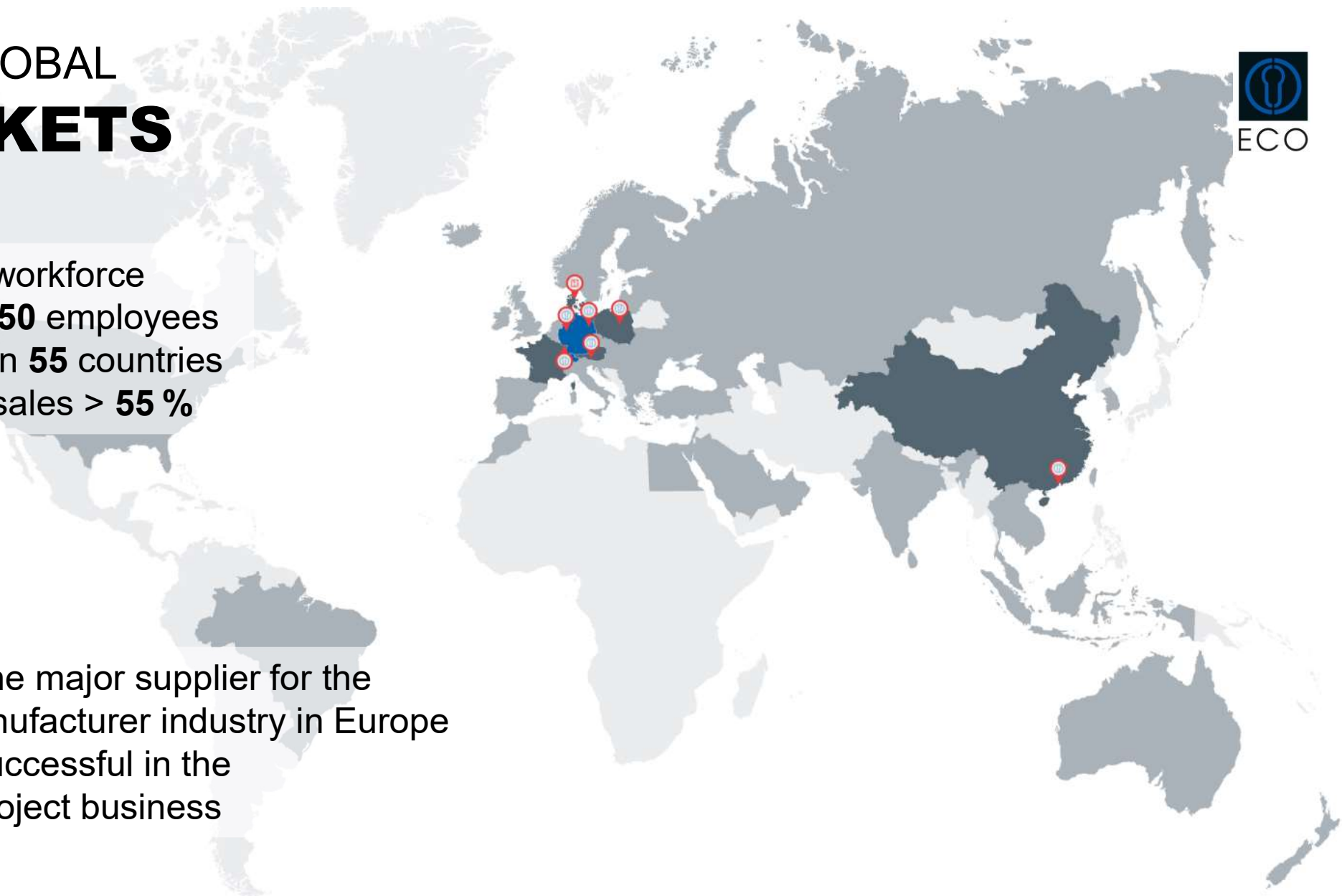

WE TAKE SAFETY PERSONALLY **STANDARDS AND CERTIFICATIONS**

When we talk about planning, ECO Schulte is referring to the process of selecting door components with the guarantee of absolute compliance with standards.

Where human lives are at stake, mechanics are the means of choice.



AESTHETIC
POWERHOUSES.
**DOOR CLOSER
TECHNOLOGY**



DOOR CLOSER TECHNOLOGY

AESTHETIC POWERHOUSES

Door closers and coordinators

- Models available with slide rail or standard arm
- Complete portfolio of coordinators (mechanical & electromagnetic)
- Stainless steel u-cover as a standard

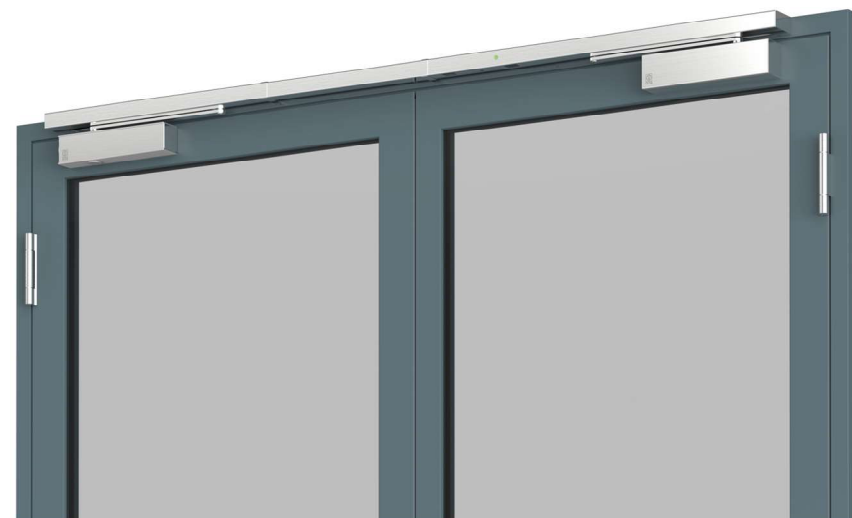

DOOR CLOSER TECHNOLOGY

AESTHETIC POWERHOUSES

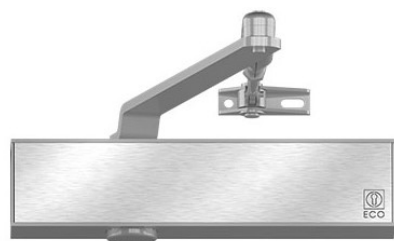

Door closers with slide rail

Designation	Tests ¹	Size acc. to EN ²	Latching speed adjustment ³	Back-check ⁴	Closing speed adjustment	Closing delay ⁵	DIN L + R / BS + BG ⁶
TS-62	F / CE	2-5 continuously	from the front	adjustable	from the front	adjustable	yes / yes ⁷
TS-61	F / CE	5-6 continuously	from the front	adjustable	from the front	-	yes / yes ⁷
TS-61	F / CE	2-5 continuously	from the front	adjustable	from the front	optional	yes / yes ⁷
TS-51	F / CE	1-4 continuously	from the front	adjustable	from the front	-	yes / yes ⁷
TS-41	F / CE	1-4 continuously	from the side	fixed	from the side	-	yes / yes
TS-31	F / CE	1-3 continuously	from the side	fixed	from the side	-	yes / yes

Standard arm closers

Designation	Tests ¹	Size acc. to EN ²	Latching speed adjustment ³	Back-check ⁴	Closing speed adjustment	Closing delay ⁵	DIN L + R / BS + BG ⁶
TS-50	F / CE	2-6 continuously	from the side	fixed	from the side	-	yes / yes
TS-20	F / CE	3 / 5	from the side	fixed	from the side	-	yes / yes
TS-14	F / CE	2 / 3 / 4	from the side	-	from the side	-	yes / yes

DOOR CLOSER TECHNOLOGY

AESTHETIC POWERHOUSES

Concealed door closer

- Models available up to EN5
- Minimum door width of 40mm for the ITS Multi Genius
- Max. opening angle of ITS Multi Genius 175 degree
- Slide for single and double leaf doors (mechanical & electromagnetic)



DOOR CLOSER TECHNOLOGY

AESTHETIC POWERHOUSES



Swing door operators

- Two models available
 - ETS-42 = EN 2-4
 - ETS-73 = EN 3-7
- Tested on maximum door weight of 500kg (ETS-73)



DOOR CLOSER TECHNOLOGY

AESTHETIC POWERHOUSES

FTA ECO Vent

- Device integrated into the Smoke and Heat Ventilation System on the facade doors
- ECO TS-62 plus FTA 600 R

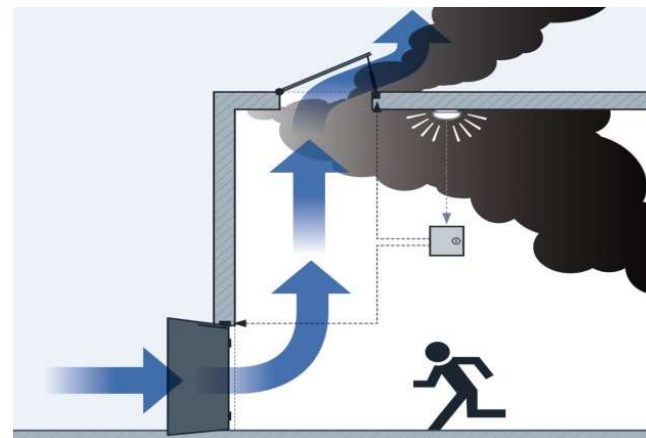



LATCHING
ON TO THINGS.

FITTING
TECHNOLOGY



GOOD, BETTER, BEST: QUALITY BEARINGS WITH A SYSTEM



OKL - Premium handles with ball-bearing technology



OKL-bearing

These high-end project handles are characterized by an industrial ball bearing. The precise and maintenance free ball bearing technology ensures a well-balanced system. Additionally the flex-bearing, lying inside the ball bearing unit, balances uneven door surfaces for up to 3 degree. This premium and innovative solution will meet all standards for private or public doors.

- EN 1906, class 4
- With spring and 90 degree carrier
- Patented flex-bearing unit
- 1 million cycle tested

OGL - Handles with friction bearing technology



OGL-bearing

The main characteristic of this handle is a maintenance free nylon bearing that is floating on the steel base rose and balancing radial and axial free-play. This class 4 handle bearing can be used on doors with high frequency and a potential for violent usage such as in schools or football stadiums.

- EN 1906, class 4
- Unsprung
- 200,000 cycle tested

SGL - Handles with standard friction bearing technology



SGL-bearing

The bearing made of glass fiber reinforced nylon is guiding the handle axial as well as radial. A wave spring is compensating angular tolerances. A perfect and certified price/performance ratio for frequently used handles in all kind of buildings.

- EN 1906, class 3
- With spring
- 200,000 cycle tested

BGL - Handles with basic friction bearing technology



BGL-bearing

The steel base rose and return spring ensure a proper and stable fixing on the door. The economic bearing is perfect for interior doors in public buildings or private houses.

- EN 1906, class 2¹
- With spring
- 200,000 cycle tested

HANDLE TECHNOLOGY LATCHING ON THINGS

OKL
Magis

OKL Magis – premium object fitting
with ball bearing technology

OKL bearing technology

The industrial ball bearing is characteristic for these high-quality object fittings. A precise and maintenance-free, fully encapsulated grooved ball bearing ensures the well-balanced, play-free mounting of the handle. The integrated flexible bearing compensates radial and axial clearance.



Performance criteria ECO OKL Magis

- EN 1906, user class 4
- 1 million test cycles, tested to MPA plus
- EN 1906, corrosion class 5
- DIN 18273 approved
for fire and smoke protection doors 
- EN 179, depending on handle shape
- DIN-L / DIN-R useable
- Type B restoring spring with 90° stop
- Fixed sleeve nuts + support cams
- High-precision **ball-bearing technology**
with flexible compensating bearing
- High-strength pin connection
- Rose dimensions Ø 55 x 9 mm
- Standard door thickness 38-45mm
and 44-66mm
- 8 mm / 9 mm fire protection

HANDLE TECHNOLOGY LATCHING ON THINGS

OGL Click – object fitting
with friction bearing technology

OGL Click bearing technology

These object fittings have a maintenance-free plastic friction bearing, which floats in the galvanized steel base rose and thus compensates the radial and axial play.



Performance criteria ECO OGL Click

- ECO **Click** quick assembly
- Damage-free removal
- **EN 1906**, user class 4
- 200,000 test cycles
- **EN 1906**, corrosion class 4
- **DIN 18273** approved
for fire and smoke protection doors **F**
- **EN 179**, depending on handle shape
- **DIN-L / DIN-R** useable
- Type A restoring spring
- Fixed sleeve nuts + support cams
- Maintenance-free handle bearing
- High-strength pin connection
- Rose dimensions $\varnothing 55 \times 9$ mm
- Standard door thickness 38-45mm
and 44-66mm
- 8 mm / 9 mm fire protection

HANDLE TECHNOLOGY LATCHING ON THINGS



SGL – object fitting
with friction bearing technology

SGL bearing technology

The lever handle is guided radially and axially in the base rose made of glass fibre reinforced plastic. Angle tolerances are compensated by a wave spring washer.

Performance criteria ECO SGL Click

- ECO **Click** quick assembly
- **EN 1906**, user class 3
- 200,000 test cycles
- **EN 1906**, corrosion class 4
- **DIN-L / DIN-R** useable
- Type A restoring spring
- Fixed sleeve nuts + support cams
- Maintenance-free handle bearing
- High-strength pin connection
- Rose dimensions Ø 55 x 9 mm
- Standard door thickness 38 - 45 mm
- 8 mm



HANDLE TECHNOLOGY LATCHING ON THINGS

OGL – Oval rose handle
with friction bearing technology

OGL bearing technology

These object fittings have a maintenance-free plastic friction bearing, which floats in the galvanized steel base rose and thus compensates the radial and axial play.

Performance criteria ECO OGL

- EN 1906, user class 4
- **1 million test cycles**, tested to **MPA plus**
- EN 1906, corrosion class 4
- DIN 18273 approved
for fire and smoke protection doors 
- EN 179, depending on handle shape
- DIN-L / DIN-R useable
- Type A restoring spring
- Available with and without support cams
- Maintenance-free handle bearing
- High-strength pin connection
- Oval rose dimension 70 x 33mm
- 8 mm / 9 mm fire protection



HANDLE TECHNOLOGY

LATCHING ON THINGS

Security handles

- Tested to various security classes as per DIN 18257 and EN 1906
- up to security class RC4
- Various external knobs and plates as option
- Bullet resistance security handle available



ALWAYS ON THE SAFE SIDE.
**PANIC & LOCKING
TECHNOLOGY**



PANIC AND LOCKING TECHNOLOGY **ALWAYS ON THE SAFE SIDE**

Wide range of panic bars and locks for every purpose



PANIC AND LOCKING TECHNOLOGY **ALWAYS ON THE SAFE SIDE**

Extensive range

- Solenoid lock for access controlled doors
- 9mm fire door locks
- Panic locks (active leaf) with upper locking for single and double leaf for timber/steel or profile frame doors
- Panic lock (passive leaf) with integrated e-strike
- Double cylinder lock
- ...



PANIC AND LOCKING TECHNOLOGY **ALWAYS ON THE SAFE SIDE**



PANIC AND LOCKING TECHNOLOGY

ALWAYS ON THE SAFE SIDE



New EPN 2000 III panic bar

- Patented gear technology
- 3 versions available
 - Mechanical
 - Motorized
 - Blocked



SUPPORTING
ROLLERS.
**HINGE
TECHNOLOGY**



HINGE TECHNOLOGY

SUPPORTING ROLLERS

Patented bearing technology

Loading capacity between 160 to 300kg

Available as a butt hinge or 3D-adjustable hinge

Worldwide unique and patented production technology



HINGE TECHNOLOGY SUPPORTING ROLLERS



Performance criteria

- Hinge class: 14
- Use class: 4, very heavy
- Long-term operability: 200,000 cycles

USPs

- Clearance-free, patented and maintenance-free premium ball bearing
- Automated, innovative production technology with minimum tolerances and gap dimensions
- No lubricants used
- Easy to clean thanks to closed hinge roller - especially suitable for hygiene-critical areas
- Opening resistance significantly under the test norm required
- Guarantee: Entire service life

Burglar resistance

- No pin securing necessary, since there is no full floating axle
- Not possible to lever out the closed hinge roller (made of solid material)

Design

- Seamless hinge design without cover head top/bottom thanks to closed hinge roller
- Attractive finish pattern thanks to longitudinal polishing
- Automated, innovative production technology with minimum tolerances thanks to laser welding technology

HINGE TECHNOLOGY

SUPPORTING ROLLERS

Certified to EN 1935 Grade 14

Maintenance- and grease-free



Ball bearing



Oil-free



Minimalistic design

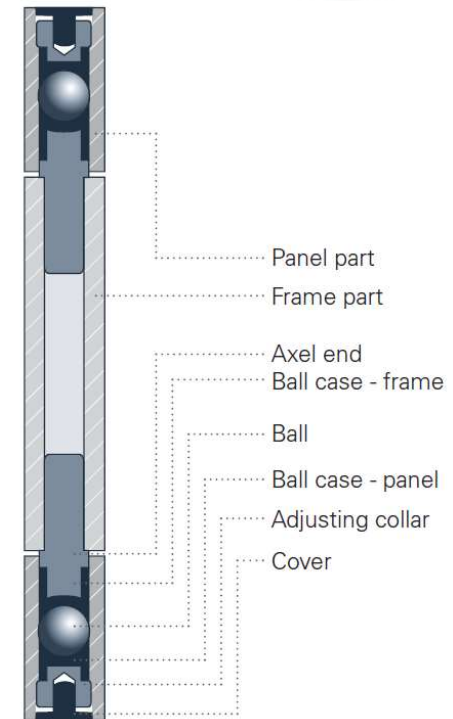

ITM: INTELLIGENT DOOR MANAGEMENT

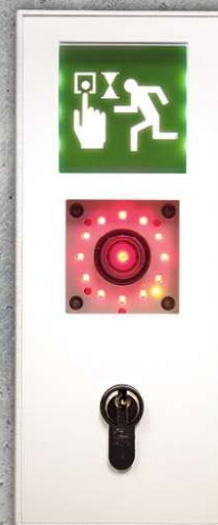

ITM

HARDWARE MEETS ELECTRONICS

Doors in a project are all individual

Mechanical perform perfect but electronic brings new comfort and endless possibilities

From stand-alone doors to fully connected smart doors

Many areas but one solution

- Smoke and fire system
- Access control system
- Security system
- Alarm system

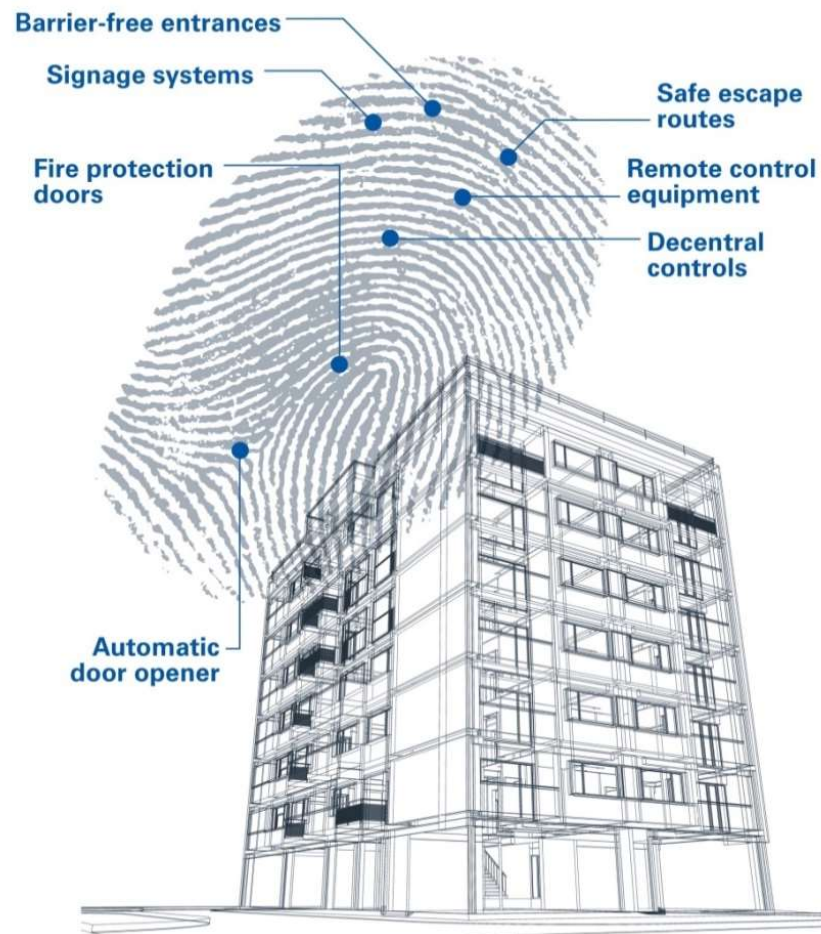

ITM

HARDWARE MEETS ELECTRONICS

Building management system

Smoke- and fire protection

Access control

Door automation

Moitored emergency exits

ITM

Intelligent door
management

Anti-Panic systems

Burglary / Safety

Alarm

Accessibility

ITM HARDWARE MEETS ELECTRONICS



- Mechatronic solution
- With fire and smoke protection function
- With panic function
- Available in various finishes
- Barrier-free solution
- Multi-functional usability
- Tested and approved technology

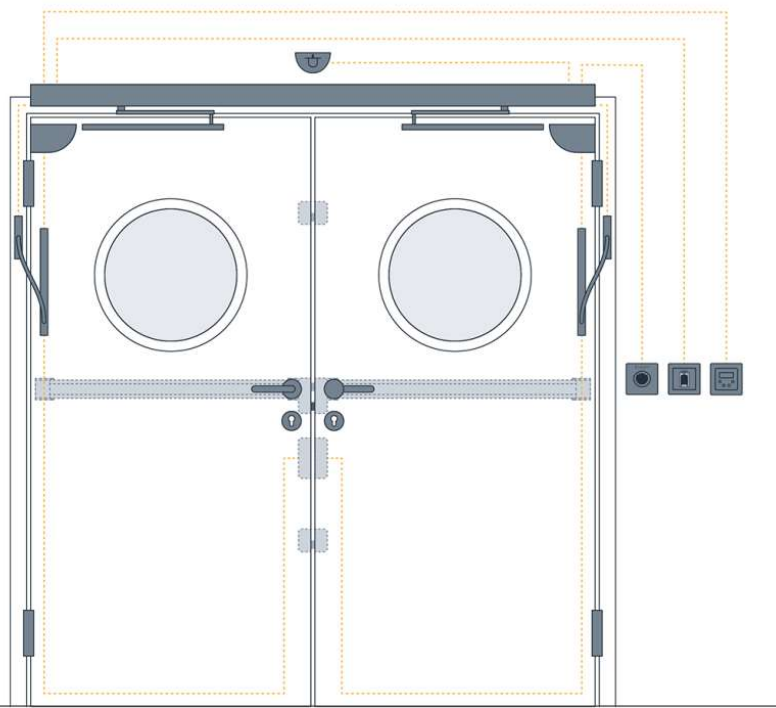

View pull side

<p>① Door closer ETS 64-IRM-SRI (GSZ)</p> <p>1x</p>	<p>② Fitting OKL Magis D-330</p> <p>2x</p>	
<p>③ PSVT EPN 2000 II + ECO Autotronic 834P + ECO GBS 99M + GBS 99</p> <p>2x 1x 1x 1x</p>	<p>④ Hinge construction hinge</p> <p>4x</p>	
<p>⑤ ITM Cable connection</p> <p>2x</p>	<p>⑥ ITM Flatscan</p> <p>2x</p>	<p>⑦ ITM Radar</p> <p>1x</p>
<p>⑧ ITM BFT</p> <p>1x</p>	<p>⑨ ITM ECO Fingerprint</p> <p>1x</p>	<p>⑩ ITM Bedix</p> <p>1x</p>

- | | |
|------------------------------------------------|-----------------------------------------------|
| <input checked="" type="checkbox"/> PUBLIC | <input checked="" type="checkbox"/> EDUCATION |
| <input checked="" type="checkbox"/> HEALTHCARE | <input checked="" type="checkbox"/> INDUSTRY |
| <input type="checkbox"/> OFFICE | <input type="checkbox"/> RESIDENTIAL |
| <input checked="" type="checkbox"/> TRANSPORT | <input checked="" type="checkbox"/> HOTEL |

NORMS:
EN 16034, EN 14846, EN 1125,
EN 1935, EN 16005, EN 18263-4,
DIN 18040, DIN 18273

PROJECT REFERENCES **GOING GLOBAL**



REFERENCES

■ SYSTEM TECHNOLOGY FOR THE DOOR

PROJECT REFERENCES

GOING GLOBAL

**Lego
Campus
Denmark**



**Adidas World
of Sport
Germany**



**Allianz
Campus
Berlin**



**Dubai Opera
House**



PROJECT REFERENCES

GOING GLOBAL

**National
Stadium
Beijing**



**National
Museum of
Qatar**



**Sportshub
Singapore**



**The Louvre
Abu Dhabi**



Many Thanks!





registered
architectural ironmonger

this is to certify that

Thalapilly Pradeep

is a Registered Architectural Ironmonger
1st April 2023 - 31st March 2024
RegAI no R1276



Chairperson



GAI Chief Executive



Thalapilly Pradeep

DipGAI, MGAI, RegAI

Registered until 31st March 2024

RegAI no R1276